

# RITEN TYPE 66



Design: Hydraulic  
Driving Diameter Range: 3.24 - 4.33 Inch

## FACE DRIVERS

### A - MOUNTING

ORDER CODE	MOUNTING STYLE	MAX. PART WEIGHT	UPC NUMBER
06	#6 Morse Taper	375 lbs.	662503-00306
F1	Flange Mount	375 lbs.	662503-00307
F2	Flange H.D.	550 lbs.	662503-00308
F3	Flange H.D.	920 lbs.	662503-00309
F4	Flange H.D.	1470 lbs.	662503-00310
F5	Flange H.D.	2940 lbs.	662503-00311

### MORSE TAPER SHANK

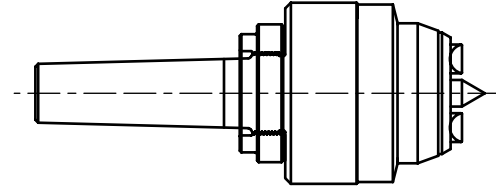

### B - DRIVE PINS - 8 Pins Required

Minimum Stock Size Should Be .030 Larger Than Driving Diameter  
Maximum Stock Size Should Be No More Than 2X Driving Diameter

ORDER CODE	DRIVING DIA.		PIN STYLE	UPC NUMBER
	Right	Left		
P6801	3.24	4.33	OFFSET	662503-00026
P6802	4.33	3.24	OFFSET	662503-00027
P6803	3.54	4.33	HALF OFFSET	662503-00028
P6804	4.33	3.54	HALF OFFSET	662503-00029
P6805	3.86	3.86	CENTRAL	662503-00030
P6806	4.33	4.33	FULL WIDTH	662503-00031

### CHUCK MOUNT

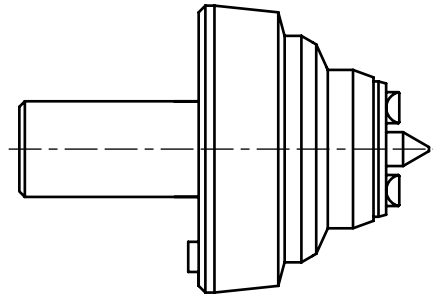

Look directly at the chuck or spindle to determine rotation:  
CLOCKWISE - USE LEFT-HAND PINS  
COUNTERCLOCKWISE - USE RIGHT-HAND PINS.

### C - CENTER POINTS

ORDER CODE	CENTER HOLE DIAMETER RANGE	UPC NUMBER
C6601	0.472 - 0.787	662503-00068
C6602	0.787 - 1.102	662503-00069
C6603	1.102 - 1.417	662503-00070
C6604	1.417 - 1.732	662503-00071
C6605	1.732 - 2.047	662503-00072
C6606	2.047 - 2.362	662503-00073
C6607	2.362 - 2.677	662503-00074
C6608	2.677 - 2.992	662503-00075
C6609	2.992 - 3.307	662503-00076
C6610	3.307 - 3.622	662503-00077

### SPINDLE ADAPTERS TYPE 66

ORDER CODE	SPINDLE SIZE	UPC NUMBER
705053	A2-6"	662503-00312
705054	A2-8"	662503-00313
705055	A2-11"	662503-00314
705056	A2-15"	662503-00315

### TO ORDER

To determine the order number of the product you want, enter the Order Code found in blue columns A, B, & C in the corresponding slots to the right. Consult the separate price list for each unit's price and add for total.

### ORDER CODE FORMULA

TYPE <b>66</b>	A - MOUNT CODE _ _ _ _	-	B - PINS CODE _ _ _ _ _	C - CENTER POINT CODE _ _ _ _ _
-------------------	---------------------------	---	----------------------------	------------------------------------

### PRICING FORMULA

A - MOUNT PRICE	+	B - PINS PRICE	+	C - POINT PRICE	=	TOTAL LIST PRICE
(Unit price times 8)						

For further assistance please call 1-800-338-0027, or complete the Information Request Sheet located on page 30 and fax to 1-800-338-0717