

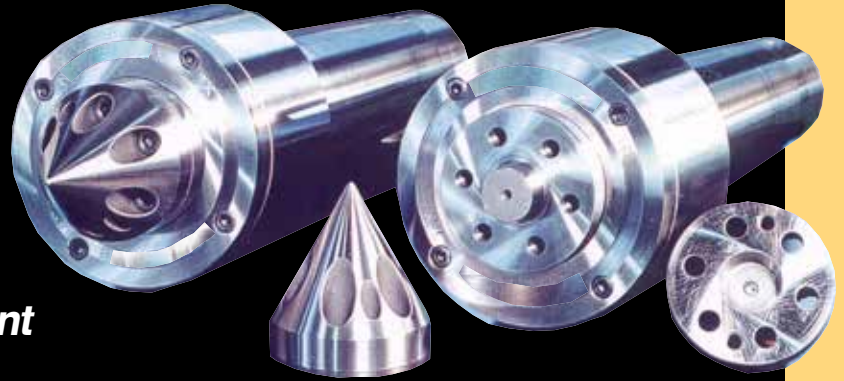

## Super Duty Live Centers Standard and Replaceable Point



- Accuracy guaranteed to  $\pm .0002$
- Designed for especially heavy workpieces such as those found in mill roll manufacturing and rebuilding.
- Unmatched rigidity under load.
- Radial and axial deflection evaluated per application.
- Two-stage/5 point testing of noise level, vibration, temperature, and accuracy under load.
- Available in metric tapers upon request

Each center is engineered for a specific application. Representative sizes and capacities are shown below. Contact Riten Technical Service to discuss your specific needs.

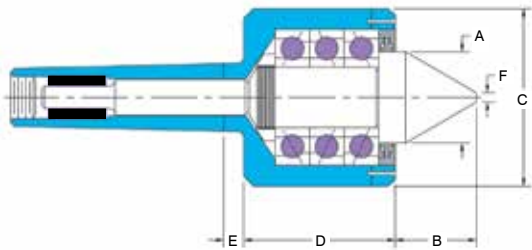

STANDARD POINT									
Model	Gage Line Dia.	A	B	C	D	E	F	Max RPM	Bearing Load Rating
N/A	3.5	3.75	3.25	8.00	6.38	0.50	0.25	1200	62,000 lbs.
N/A	4.5	4.25	5.00	9.75	7.25	0.63	0.38	900	69,500 lbs.
N/A	5	5.00	5.63	10.75	7.75	0.75	0.50	800	105,000 lbs.
N/A	6	6.00	5.75	11.38	8.63	0.88	0.75	600	125,000 lbs.

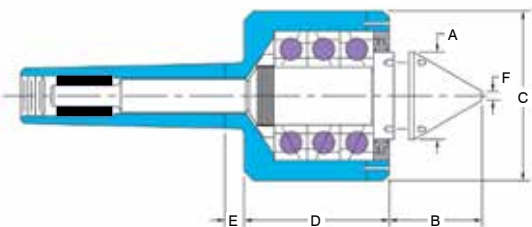

REPLACEABLE POINT									
Model	Gage Line Dia.	A	B	C	D	E	F	Max RPM	Bearing Load Rating
N/A	3.5	3.75	4.25	8.00	6.38	0.50	0.25	1200	62,000 lbs.
N/A	4.5	4.25	4.75	9.75	7.25	0.63	0.38	900	69,500 lbs.

Applications requiring bearing load ratings from 120,000 to 450,000 lbs. are available. For application assistance and available product configurations, please contact Riten Technical Support Group at 1-800-338-0027.

Standard contact angle is 60°. Optional contact angles of 45°, 70°, 80° and 90° are also available.